



XSPEC XFRAME - Grenadier Fitting Instruction



KIT INCLUDES:

- 1 x SLRV XSPEC 'XFRAME'
- 2 x Tie down bar brackets
- 2 x Tied down bar protection sleeves
- 2 x Utility Rail fittings
- 4 x M6 x 16 SS hex screws with washers

TOOLS REQUIRED:

- M5 allen key (supplied)
- M10 Spanner / Socket
- NOTE: Accessories can be pre mounted to the XFRAME before fitment to the vehicle OR fitted afterwards by leaving the utility rail fittings off and rotating the XFRAME upwards to secure hardware. Utility rail fittings should then be fitted and all mounts tightened as per instructions.



XSPEC XFRAME - Grenadier Fitting Instruction



- Note: If a Rhino factory roofrack is fitted, slide the unit back so it is flush with the rear of the Grenadier as pictured.

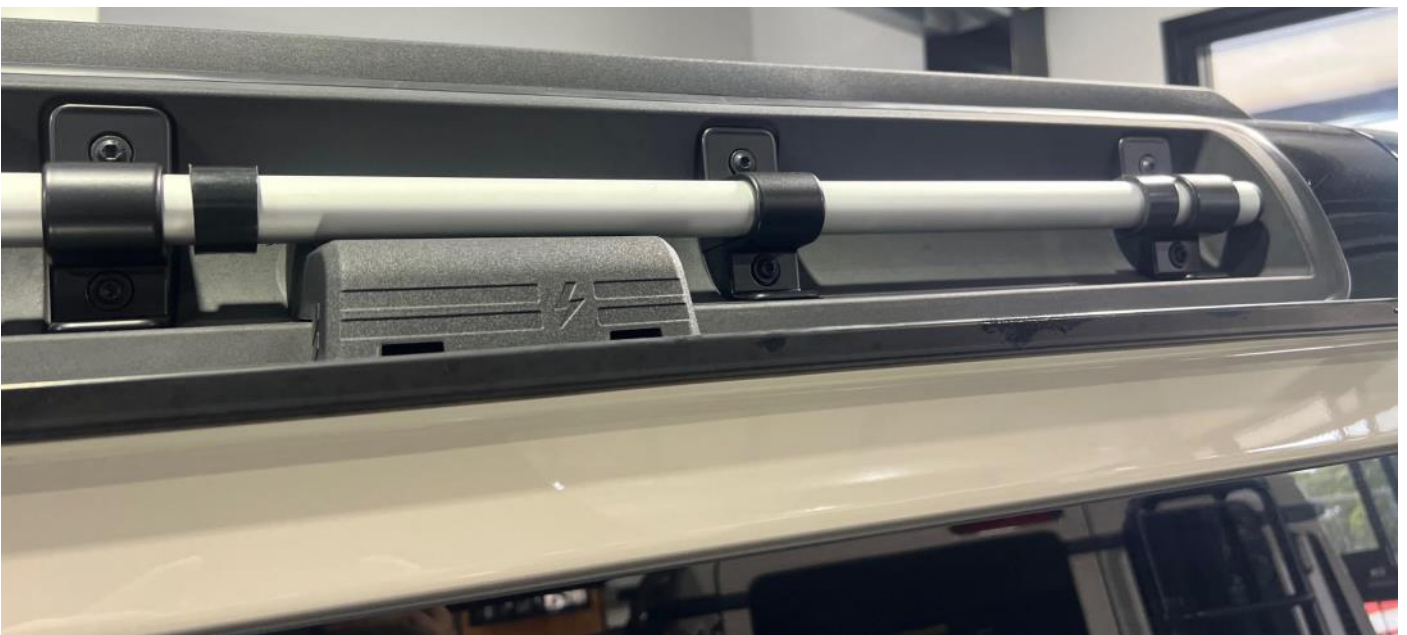

- Place tie down bar protection sleeves on bar as pictured



XSPEC XFRAME - Grenadier Fitting Instruction



- Fit tie down bar brackets over the sleeves using M5 allen key provided. *Medium Loctite should be used on all threads. Tighten down screws evenly on both sides of each bracket until snug. Brackets should still be able to rotate and slide along the bar. Brackets should be at 45 degree angle approx. as pictured.



XSPEC XFRAME - Grenadier Fitting Instruction



- Hold XFRAME in position (if fitting with accessories already attached you will require assistance), adjust or rotate mounting brackets as necessary to align with holes and insert 4 off M6 x 16 hex screws with flat and spring washers as pictured. Hand tighten these 4 screws.



XSPEC XFRAME - Grenadier Fitting Instruction



- Slide the XFRAME and brackets left or right to align with the edge of the rear window. Ensure protective sleeves remain in place under the mounting brackets. Once the XFRAME is aligned with the window, remove the top 4 bolts and tighten down the tie down bar brackets on the rail. Re fit the XFRAME and tighten the 4 bolts. XFRAME will still be able to rotate vertically about the tie down bar brackets.



XSPEC XFRAME - Grenadier Fitting Instruction

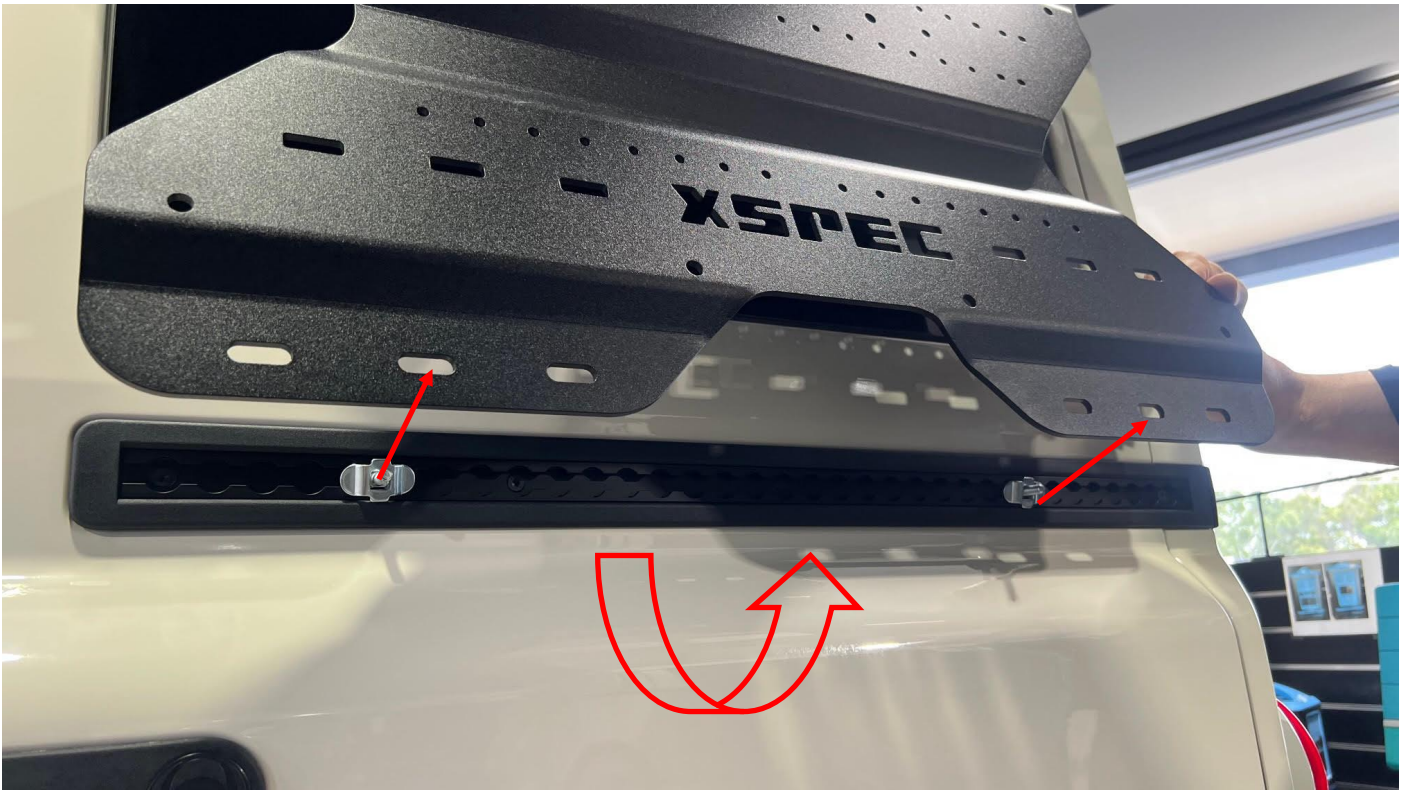

- Position the two utility rail fittings in the rail so they align with the centre, holes on the bottom of the XFRAME. *Take care - Bolt heads should be locked in place behind the rail so they cant come out. A piece of electrical tape can be used top and bottom to hold the fitting in place while fitting.

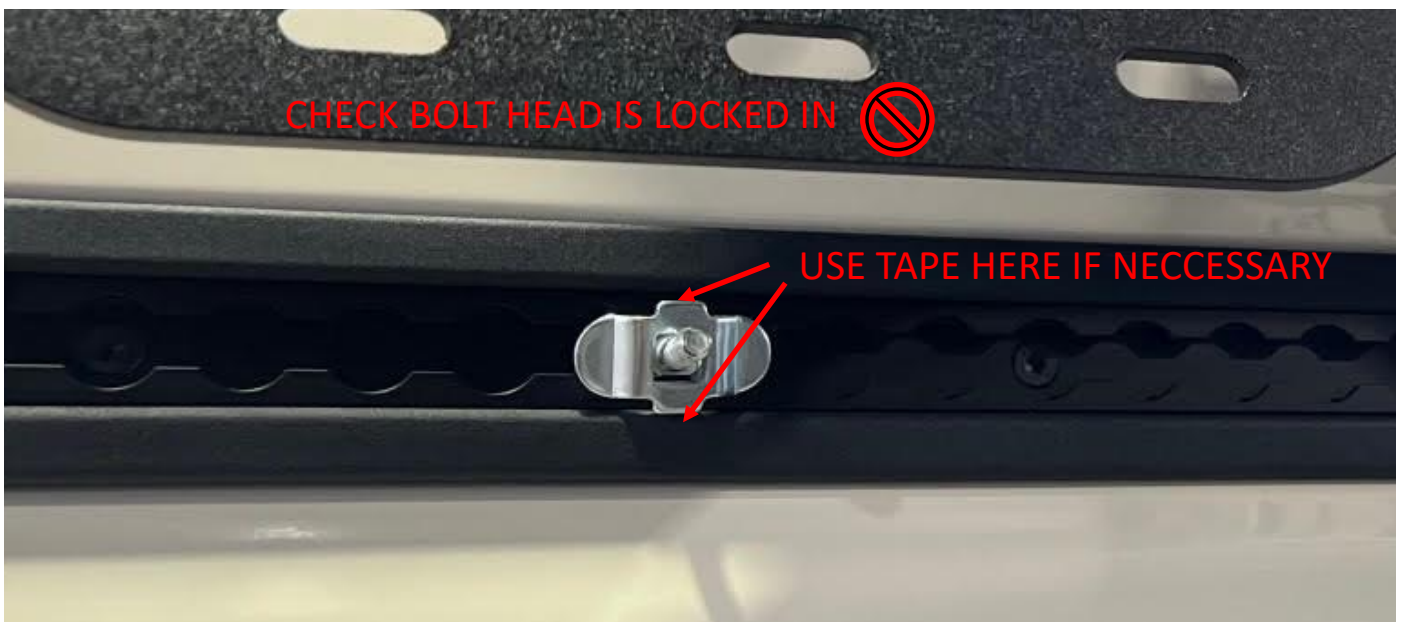



XSPEC XFRAME - Grenadier Fitting Instruction



- Lower XFRAME (making sure Utility Rail fittings stay in place)



XSPEC XFRAME - Grenadier Fitting Instruction



- Fit flat washer and nylock nut to utility rail fittings.



XSPEC XFRAME - Grenadier Fitting Instruction

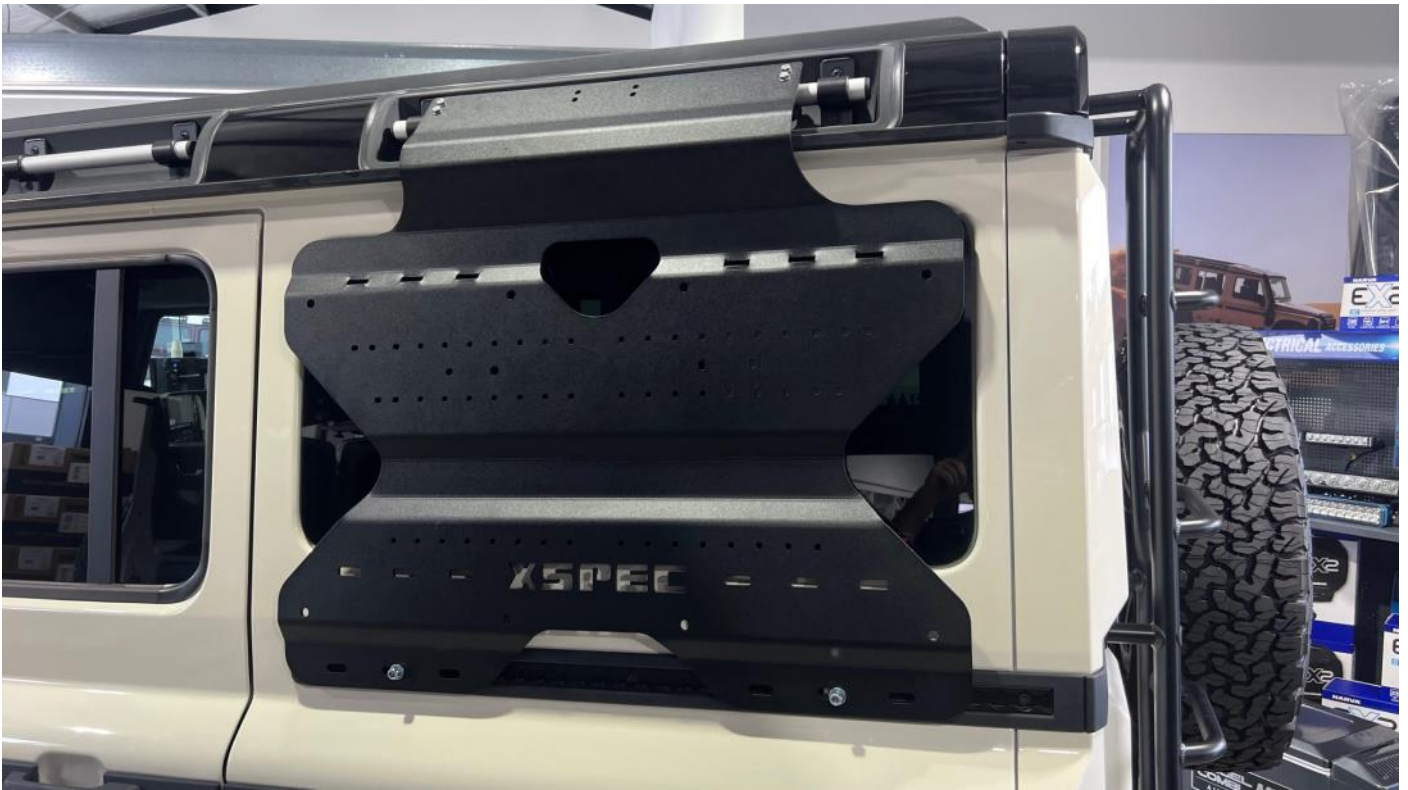

- Tighten top and bottom hardware until snug. *Do not overtighten. Your XFRAME is ready to go.
- XFRAME's are limited to 40kg capacity per side.